

Divisions affected: *Churchill & Lye Valley, Leys, North Hinksey, University Parks, Headington & Quarry, Isis, Barton, Sandhills & Risinghurst,*

**CABINET MEMBER FOR HIGHWAY MANAGEMENT
25 MAY 2023**

**OXFORD - VARIOUS LOCATIONS: PROPOSED DISABLED
PERSONS PARKING PLACES**

Report by Corporate Director, Environment and Place

RECOMMENDATION

1. The Cabinet Member for Highway Management is RECOMMENDED to approve:
 - a. The proposed provision of Disabled Persons Parking Places (DPPP) at: Gentian Road, Norreys Road, Park Town, Stile Road, Waynflete Road, Wharton Road,
 - b. the proposed formalisation of DPPP at: Wylie Close,
 - c. to defer approval of the proposals at the following location pending further investigations: Sunningwell Road,
 - d. to defer approval of the proposals to remove a DPPP at: Corunna Crescent.

Executive summary

2. The provision of Disabled Persons Parking Places is reviewed when requested by members of the public, Councillors or following observations made by officers. Specific proposals are assessed applying national regulations and guidance on the suitability of providing new bays or amending or removing existing ones. Together with a view to make the most efficient use of space while reducing sign clutter.

Financial Implications

3. Funding for the proposed changes has been provided from the County Council's revenue budget.

Equalities and Inclusion Implications

The provision of disabled persons parking places assists those with a mobility impairment

Sustainability implications

4. The proposals would help facilitate the mobility of disabled persons in the vicinity of their places of residence or work.

Introduction

5. This report presents comments received in the course of the statutory consultation on the proposals to remove, amend and introduce disabled persons parking places (DPPP's) at various locations in Oxford.

Background

6. The above proposals have been put forward following requests from residents, including – where a new place has been requested - an assessment of eligibility, applying the national guidelines on the provision part of such parking places. **Annex 1** to **Annex 9** provide plans of the locations for which responses have been received or concerns raised.

Formal consultation

7. The formal consultation on the proposals for various Oxford locations was carried out between 2 March and 31 March 2023. A notice was published in the Oxford Times newspaper and an email sent to statutory consultees & key-stakeholders, including Thames Valley Police, the Fire & Rescue Service, Ambulance service, Bus operators, countywide transport, access & disabled peoples user groups, pedestrian & cycle groups, local business groups, Oxford City Council, the local City Cllrs, and the local County Councillors representing the affected divisions.
8. Public notices were also placed on site, and letters sent directly to properties in the immediate vicinity adjacent to the proposals.
9. Nineteen responses were received from members of the public during the course of the consultation, and these are summarised in the table below:

| Location | Support | Object | Concerns |
|----------------------------|---------|--------|----------|
| Corunna Crescent (Removal) | - | 1 | 2 |
| Gentian Road | 1 | - | - |
| Norreys Road | 2 | - | - |
| Park Town | 1 | - | - |
| Stile Road | 1 | 1 | - |

| | | | |
|-----------------------------|---|---|---|
| Sunningwell Road | - | 4 | 2 |
| Waynflote Road | 1 | - | - |
| Wharton Road | - | 1 | - |
| Wylie Close (Formalisation) | 1 | - | 1 |

10. The responses are recorded in **Annex 10**, and copies of the full responses are available for inspection by County Councillors

Officer response to objections/concerns

11. Comments and recommendations are provided in response to the concerns and objections as given in Annex 10 in respect of each of the proposed sites in the following paragraphs

12. Thames Valley Police responded expressing no objection to the proposals.

Corunna Crescent – proposed removal of DPPP

13. Two expressions of concern and one objection to the removal were raised: the disabled parking place is still in use. It is recommended to retain the DPPP.

Gentian Road – proposed DPPP

14. One expression of support was raised; very happy with the location: It is recommended that this proposal is approved.

Norreys Road – proposed DPPP

15. Two expressions of support were raised; a second DPPP is badly needed: It is recommended that this proposal is approved.

Park Town – proposed DPPP

16. One expression of support was raised; I support the creation of a DPPP for my neighbour: It is recommended that this proposal is approved.

Stile Road – proposed DPPP

17. One objection and one expression of support was raised; objecting to turning the current permit holders only parking bay into a disabled parking place as parking is limited: Applicant currently parks in the Permit holders parking bay; it is recommended that this proposal is approved.

Sunningwell Road – proposed DPPP

18. Four objections and two expressions of concern was raised; suggestions were to locate the DPPP on the south side of the road where it could be better utilised

and would not hinder access for larger vehicle deliveries to the public house: It is recommended that this proposal is deferred pending further investigations on a more suitable location.

Waynflete Road – proposed DPPP

19. One expression of support was raised; ensure the DPPP does not hinder access to driveways: it is recommended that this proposal is approved.

Wharton Road – proposed DPPP

20. One objection was raised; strongly objects to the location of the proposed DPPP: the off-street parking is used by an electric vehicle owned by another family member; therefore, the blue badge holder needs to park on the highway, the location chosen was closest to their property: it is recommended that this proposal is approved.

Wylie – proposed formalisation of DPPP

21. One expressions of support and one expression of concern was raised: the DPPP has enabled me to support my son's needs, concerns were raised over the lack of parking: it is recommended to approve the formalisation of the informal DPPP, further investigations to be carried out on the removal of the other existing DPPP in the Close.

Bill Cotton
Corporate Director, Environment and Place

Annexes: Annex 1 - 9: Plans of proposed disabled parking places to be removed or provided where an objection or concern on the proposal has been received.
Annex 10: Consultation responses

Contact Officers: Tim Shickle 07920 591545
Jane Clark 07718 657180

May 2023

Drawing No.

ANNEX 1

Key



Proposed REMOVAL of Disabled Persons Parking Place

Reproduced from the Ordnance Survey mapping with the permission of the Controller of Her Majesty's Stationery Office © Crown Copyright. Unauthorised reproduction infringes Crown Copyright, and may lead to prosecution or civil proceedings. Oxfordshire County Council Licence No LK079805

| Rev. | Date | Purpose of revision | Drawn | Checked | Approved |
|------|------|---------------------|-------|---------|----------|
| | | | | | |

 **OXFORDSHIRE COUNTY COUNCIL**
 Bill Cotton
 Corporate Director for
 Environment and Place
 Communities
 Oxfordshire County Council
 County Hall
 Oxford
 OX1 1ND
 Tel: 0345 203 11 11
 Fax: 01865 241577

Project title
PROPOSED REMOVAL OF DISABLED PERSONS PARKING PLACE

Drawing title
OXFORD CORUNNA CRESCENT

Drawing Status

| Scale @ A3 | Drawn by | Checked by | Approved by |
|------------|---------------------|--------------|---------------|
| N.T.S. | JwC | JwC | JwC |
| | Date drawn 01/23 | Date checked | Date approved |

Oxfordshire Project No. & File Ref

Drawing No. Revision 0



Drawing No.

ANNEX 2

Key

 Proposed Disabled Persons Parking Place

Reproduced from the Ordnance Survey mapping with the permission of the Controller of Her Majesty's Stationery Office © Crown Copyright. Unauthorised reproduction infringes Crown Copyright, and may lead to prosecution or civil proceedings.
 Oxfordshire County Council Licence No LA079805

| Rev. | Date | Purpose of revision | Drawn | Checked | Approved |
|------|------|---------------------|-------|---------|----------|
| | | | | | |

 **OXFORDSHIRE COUNTY COUNCIL**
 88 Colton
 Corporate Director for
 Environment and Place
 Communities
 Oxfordshire County Council
 County Hall
 Oxford
 OX1 1ND
 Tel: 01865 210 11 11
 Fax: 01865 241577

Project title
**PROPOSED DISABLED PERSONS
 PARKING PLACE**

Drawing title
**OXFORD
 GENTIAN ROAD**

Drawing Status

| Scale @ A3 | Drawn by | Checked by | Approved by |
|------------|-------------------|---------------|----------------|
| N.T.S. | JwC | JwC | JwC |
| | Date drawn: 01/23 | Date checked: | Date approved: |

Oxfordshire Project No. & File Ref

Drawing No. Revision 0

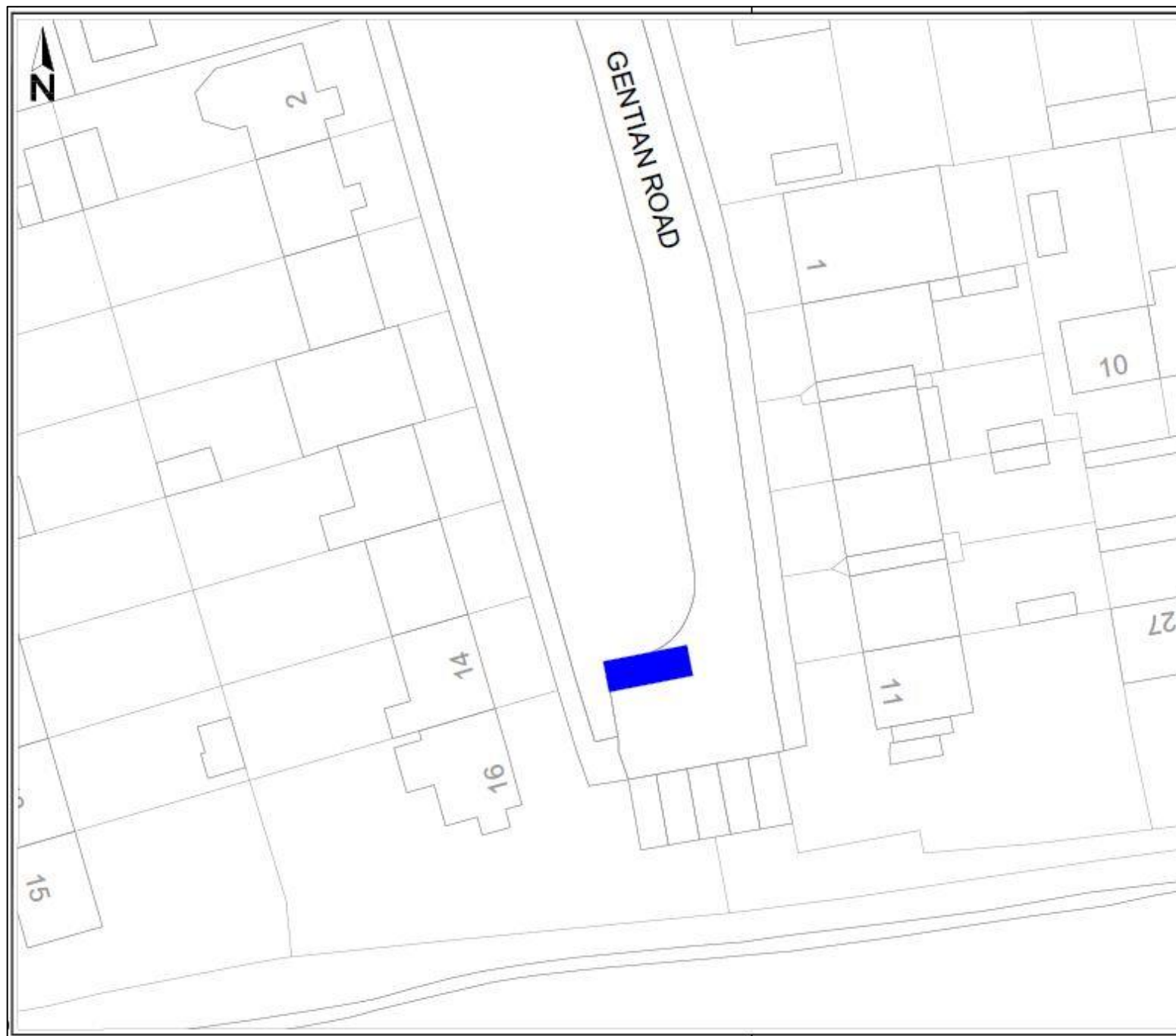

Key

- Proposed Disabled Persons Parking Place
- Existing Disabled Persons Parking Place to remain

Reproduced from the Ordnance Survey mapping with the permission of the Controller of Her Majesty's Stationery Office © Crown Copyright. Unauthorised reproduction infringes Crown Copyright, and may lead to prosecution or civil proceedings. Oxfordshire County Council Licence No LA079805

| Rev. | Date | Purpose of revision | Drawn | Checked | Approved |
|------|------|---------------------|-------|---------|----------|
| | | | | | |



OXFORDSHIRE COUNTY COUNCIL
 Bill Cotton
 Corporate Director for Environment and Place
 Communities
 Oxfordshire County Council
 County Hall
 Oxford
 OX1 1ND
 Tel: 0345 203 11 11
 Fax: 03455 241577

Project title
PROPOSED DISABLED PERSONS PARKING PLACE

Drawing title
OXFORD NORREYS AVENUE

Drawing Status

| Scale @ A3 | Drawn by | Checked by | Approved by |
|------------|--------------------------|----------------------|--------------------|
| N.T.S. | JwC Date drawn: 01/23 | JwC Date checked: | Date approved: |

Oxfordshire Project No. & File Ref

Drawing No. Revision **0**



Drawing No.

ANNEX 4

Key



Proposed Disabled Persons
Parking Place

Reproduced from the Ordnance Survey mapping with the permission of the Controller of Her Majesty's Stationery Office © Crown Copyright. Unauthorised reproduction infringes Crown Copyright, and may lead to prosecution or civil proceedings.
Oxfordshire County Council Licence No LA039605

| Rev. | Date | Purpose of revision | Drawn | Checked | Approved |
|------|------|---------------------|-------|---------|----------|
| | | | | | |



Bill Cotton
Corporate Director for
Environment and Place
Committees
Oxfordshire County Council
County Hall
Oxford
OX1 1AD
Tel: 0345 210 11 11
Fax: (01865) 241577

Project title

**PROPOSED DISABLED PERSONS
PARKING PLACE**

Drawing title

**OXFORD
PARK TOWN**

Drawing Status

| Scale @ A3 | Drawn by | Checked by | Approved by |
|------------|--------------|--------------|--------------|
| N.T.S. | JAC 01/03 | JAC 01/03 | JAC 01/03 |

Oxfordshire Project No. & File Ref

Drawing No.

Revision **0**

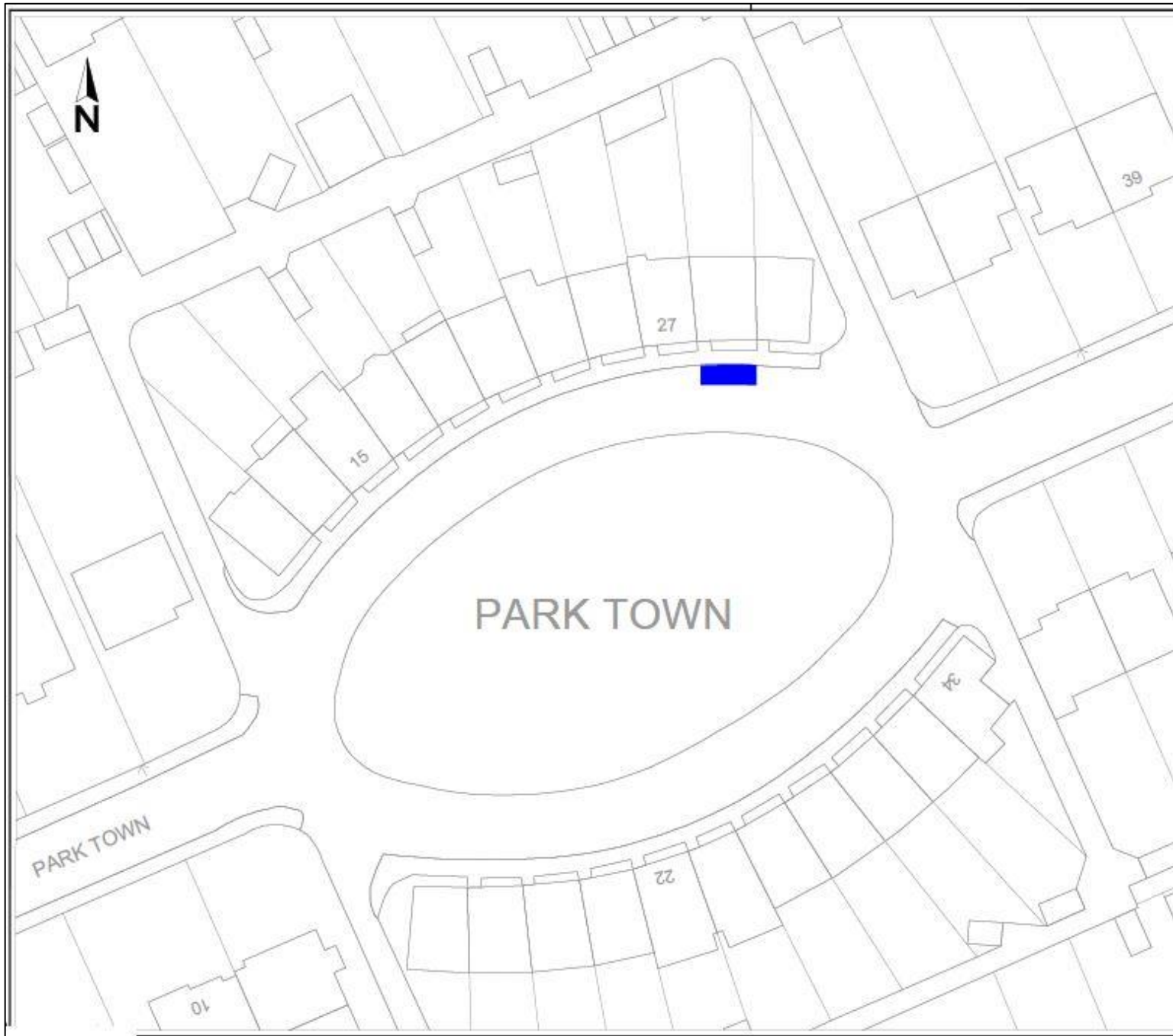

Drawing No. _____

ANNEX 5

Key

 Proposed Disabled Persons Parking Place

Reproduced from the Ordnance Survey mapping with the permission of the Controller of Her Majesty's Stationery Office © Crown Copyright. Unauthorised reproduction infringes Crown Copyright, and may lead to prosecution or civil proceedings.
Oxfordshire County Council Licence No. LA079605

| Rev. | Date | Purpose of revision | Drawn | Checked | Approved |
|------|------|---------------------|-------|---------|----------|
| | | | | | |

 **OXFORDSHIRE COUNTY COUNCIL**
 Bill Cotton
 Corporate Director for
 Environment and Place
 Communities
 Oxfordshire County Council
 County Hall
 Oxford
 OX1 1HD
 Tel: 0345 203 11 11
 Fax: (01865) 241577

Project title
**PROPOSED DISABLED PERSONS
 PARKING PLACE**

Drawing title
**OXFORD
 STILE ROAD**

Drawing Status

| Scale @ A3 | Drawn by | Checked by | Approved by |
|------------|--------------------|---------------------|---------------|
| N.T.S. | WJS drawn 01/23 | JwC Date checked | Date approved |

Oxfordshire Project No. & File Ref

Drawing No. _____ Revision **0**

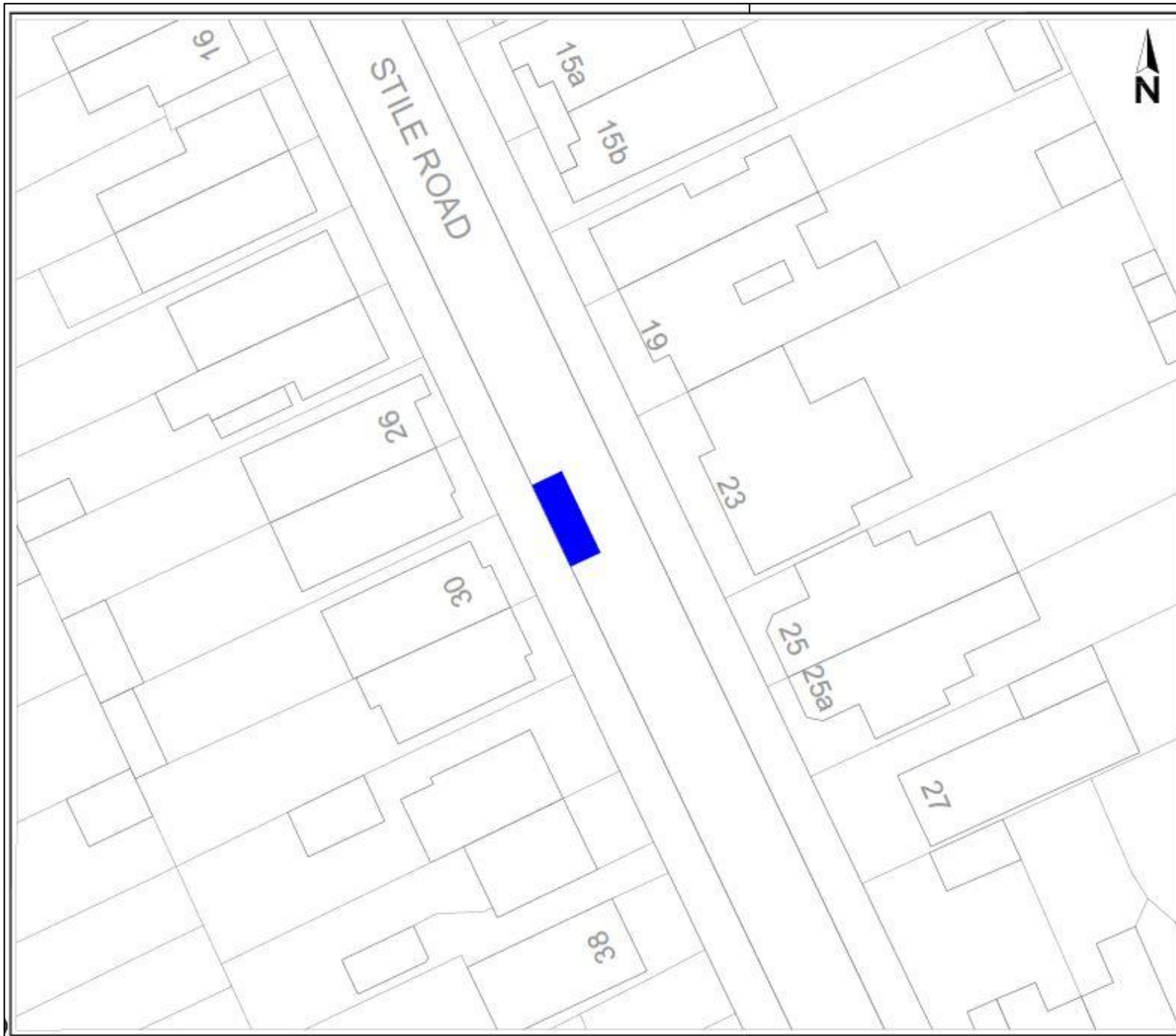

Drawing No.

ANNEX 6

Key

-  Proposed Disabled Persons Parking Place

Reproduced from the Ordnance Survey mapping with the permission of the Controller of Her Majesty's Stationery Office © Crown Copyright. Unauthorised reproduction infringes Crown Copyright, and may lead to prosecution or civil proceedings.
Oxfordshire County Council Licence No. LA078808

| Rev. | Date | Purpose of revision | Drawn | Checked | Approved |
|------|------|---------------------|-------|---------|----------|
| | | | | | |



Bill Cotton
Corporate Director for
Environment and Place
Committees
Oxfordshire County Council
County Hall
Oxford
OX1 1ND
Tel: 01865 203 11 11
Fax: 01865 241877

Project title
**PROPOSED DISABLED PERSONS
PARKING PLACE**

Drawing title
**OXFORD
WAYNFLETE ROAD**

Drawing Status

| Scale @ A3 | Drawn by | Checked by | Approved by |
|------------|---------------------|--------------|---------------|
| N.T.S. | JwC | | |
| | Date drawn 01/23 | Date checked | Date approved |

Oxfordshire Project No. & File Ref

| | |
|-------------|----------|
| Drawing No. | Revision |
| | 0 |

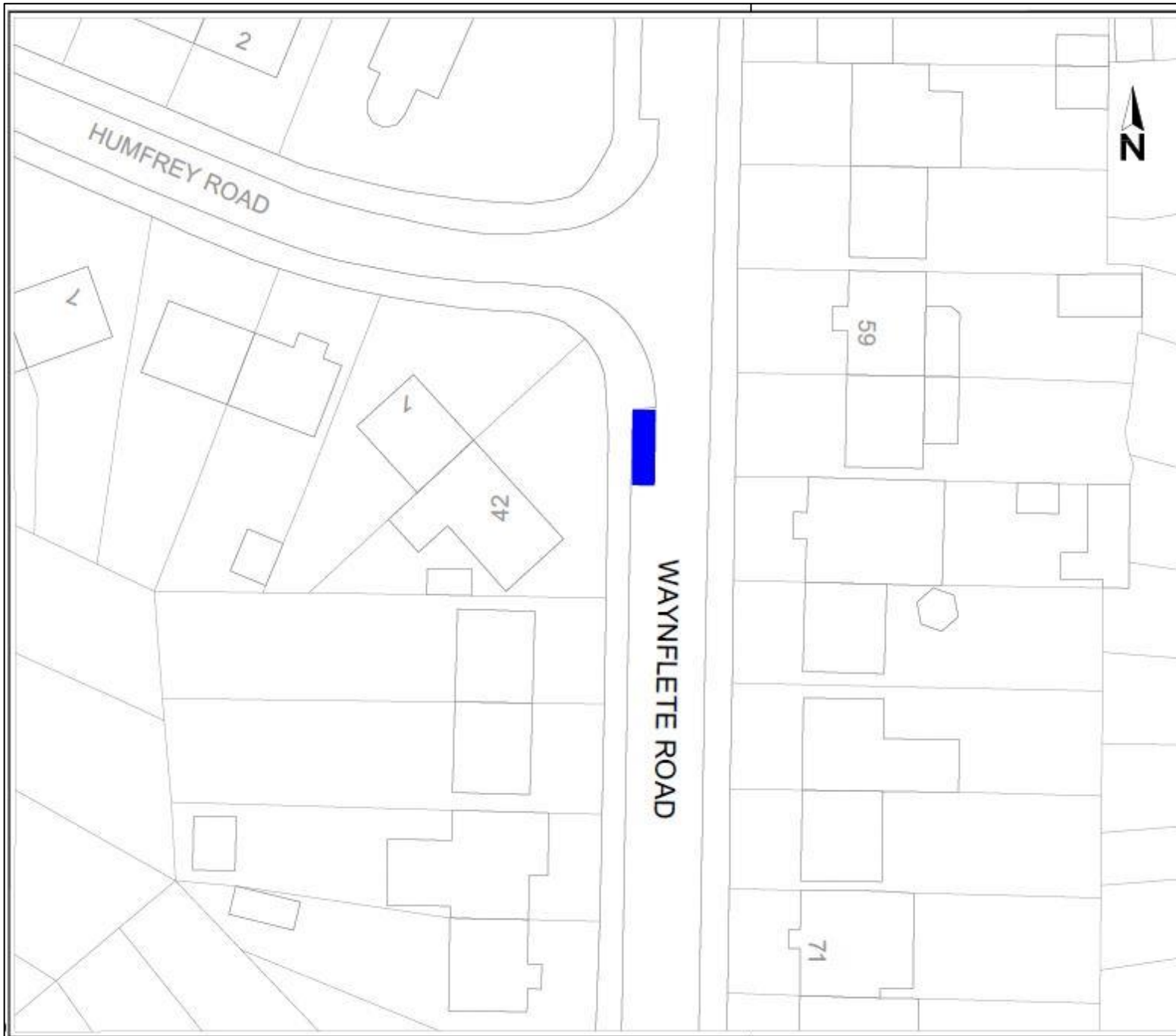

Key

 Proposed Disabled Persons Parking Place

Reproduced from the Ordnance Survey mapping with the permission of the Controller of Her Majesty's Stationery Office © Crown Copyright. Unauthorised reproduction infringes Crown Copyright, and may lead to prosecution or civil proceedings. Oxfordshire County Council Licence No. LA079805

| Rev. | Date | Purpose of revision | Drawn | Checked | Approved |
|------|------|---------------------|-------|---------|----------|
| | | | | | |

 **OXFORDSHIRE COUNTY COUNCIL**

Bill Cotton
Corporate Director for
Environment and Place
Committees
Oxfordshire County Council
County Hall
Oxford
OX1 1HJ
Tel: 0245 203 11 11
Fax: 02456 241577

Project title
**PROPOSED DISABLED PERSONS
PARKING PLACE**

Drawing title
**OXFORD
SUNNINGWELL ROAD**

Drawing Status

| Scale @ A3 | Drawn by | Checked by | Approved by |
|------------|---------------------|--------------|---------------|
| N.T.S. | JJC | JJC | JJC |
| | Date drawn 01/23 | Date checked | Date approved |

Oxfordshire Project No. & File Ref

Drawing No. **ANNEX 7** Revision **0**

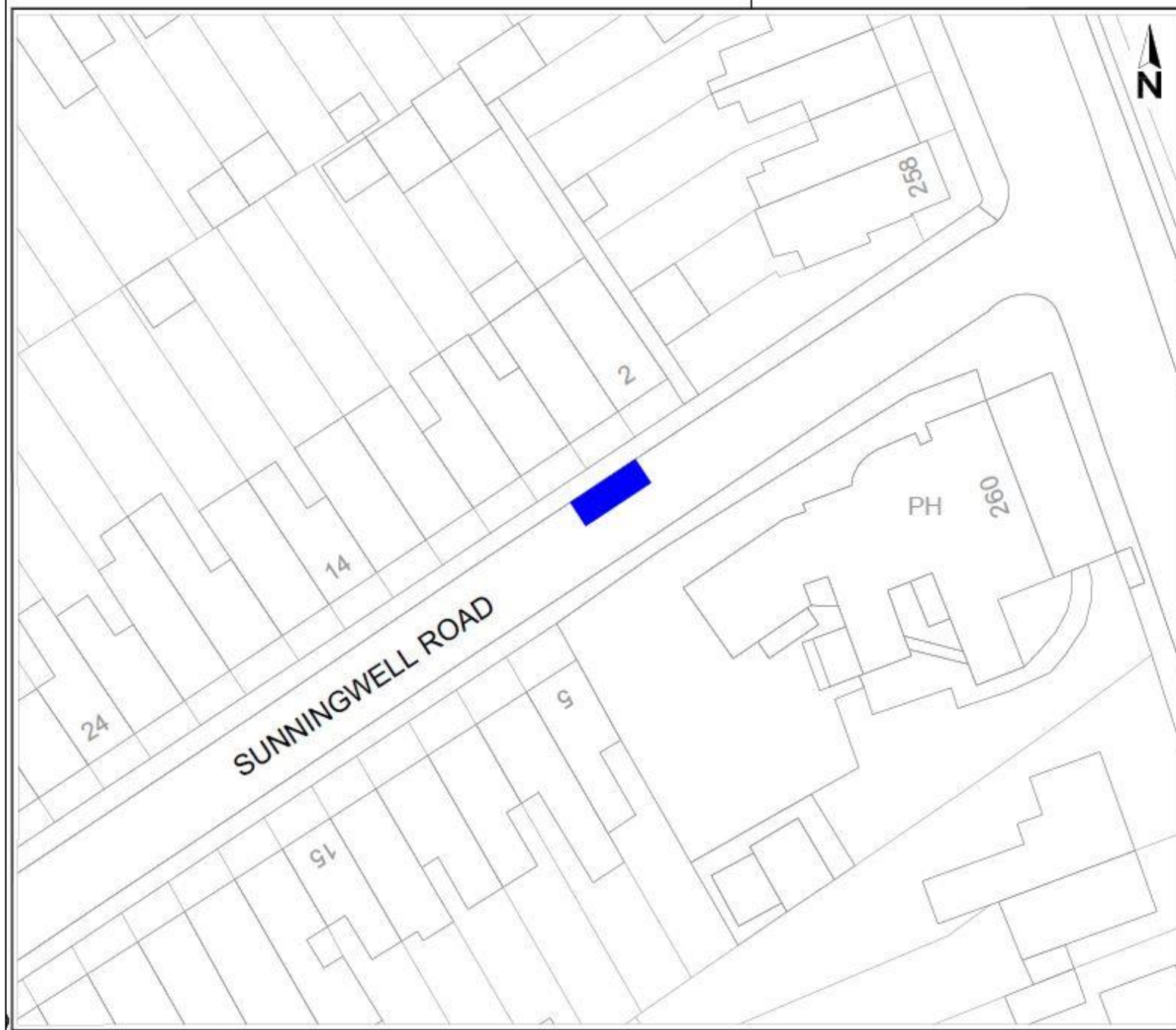

Drawing No.

ANNEX 8

Key

-  Proposed Disabled Persons Parking Place

Reproduced from the Ordnance Survey mapping with the permission of the Controller of Her Majesty's Stationery Office © Crown Copyright. Unauthorised reproduction infringes Crown Copyright, and may lead to prosecution or civil proceedings.
 Ordnance Survey Licence No. LA079805

| Rev. | Date | Purpose of revision | Drawn | Checked | Approved |
|------|------|---------------------|-------|---------|----------|
| | | | | | |

 **OXFORDSHIRE COUNTY COUNCIL**

Bill Cotton
 Corporate Director for
 Environment and Place
 Communities
 Oxfordshire County Council
 County Hall
 Oxford
 OX1 1HD
 Tel: 0345 203 11 11
 Fax: 01865 241577

Project title
**PROPOSED DISABLED PERSONS
 PARKING PLACE**

Drawing title
**OXFORD
 WHARTON ROAD**

Drawing Status

| Scale @ A3 | Drawn by | Checked by | Approved by |
|------------|---------------------|--------------|---------------|
| N.T.S. | Jed | Jed | Jed |
| | Date drawn 01/23 | Date checked | Date approved |

Oxfordshire Project No. & File Ref

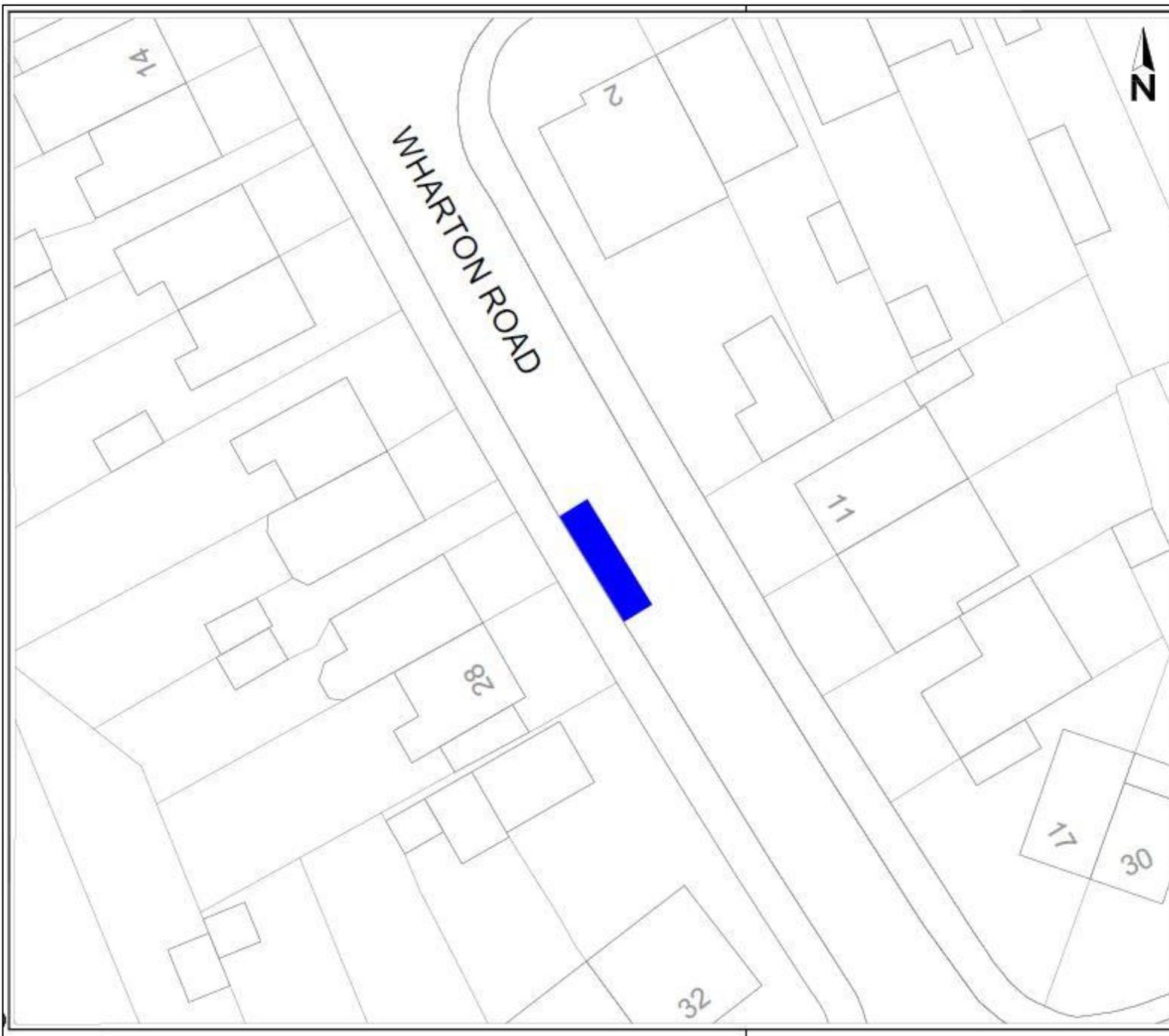

Drawing No. Revision **0**



Drawing No.

ANNEX 9

Key

-  Informal Disabled Persons Parking Place to be made formal
-  Existing relocated Disabled Persons Parking Place

Reproduced from the Ordnance Survey mapping with the permission of the Controller of Her Majesty's Stationery Office © Crown Copyright. Unauthorised reproduction infringes Crown Copyright, and may lead to prosecution or civil proceedings. Oxfordshire County Council Licence No. LA079806

| Rev. | Date | Purpose of revision | Drawn | Checked | Approved |
|------|------|---------------------|-------|---------|----------|
| | | | | | |

OXFORDSHIRE COUNTY COUNCIL
 Bill Cotton
 Corporate Director for
 Environment and Place
 Communities
 Oxfordshire County Council
 County Hall
 Oxford
 OX1 1HD
 Tel: 01865 243 11 11
 Fax: 01865 243 577

Project title
**INFORMAL DISABLED PERSONS
 PARKING PLACE TO BE MADE FORMAL**

Drawing title
**OXFORD
 WYLIE CLOSE**

Drawing Status

| Scale @ A3 | Drawn by | Checked by | Approved by |
|------------|---------------------|--------------|---------------|
| N.T.S. | JwC | JwC | JwC |
| | Date drawn 01/23 | Date checked | Date approved |

Oxfordshire Project No. & File Ref

Drawing No. Revision 0

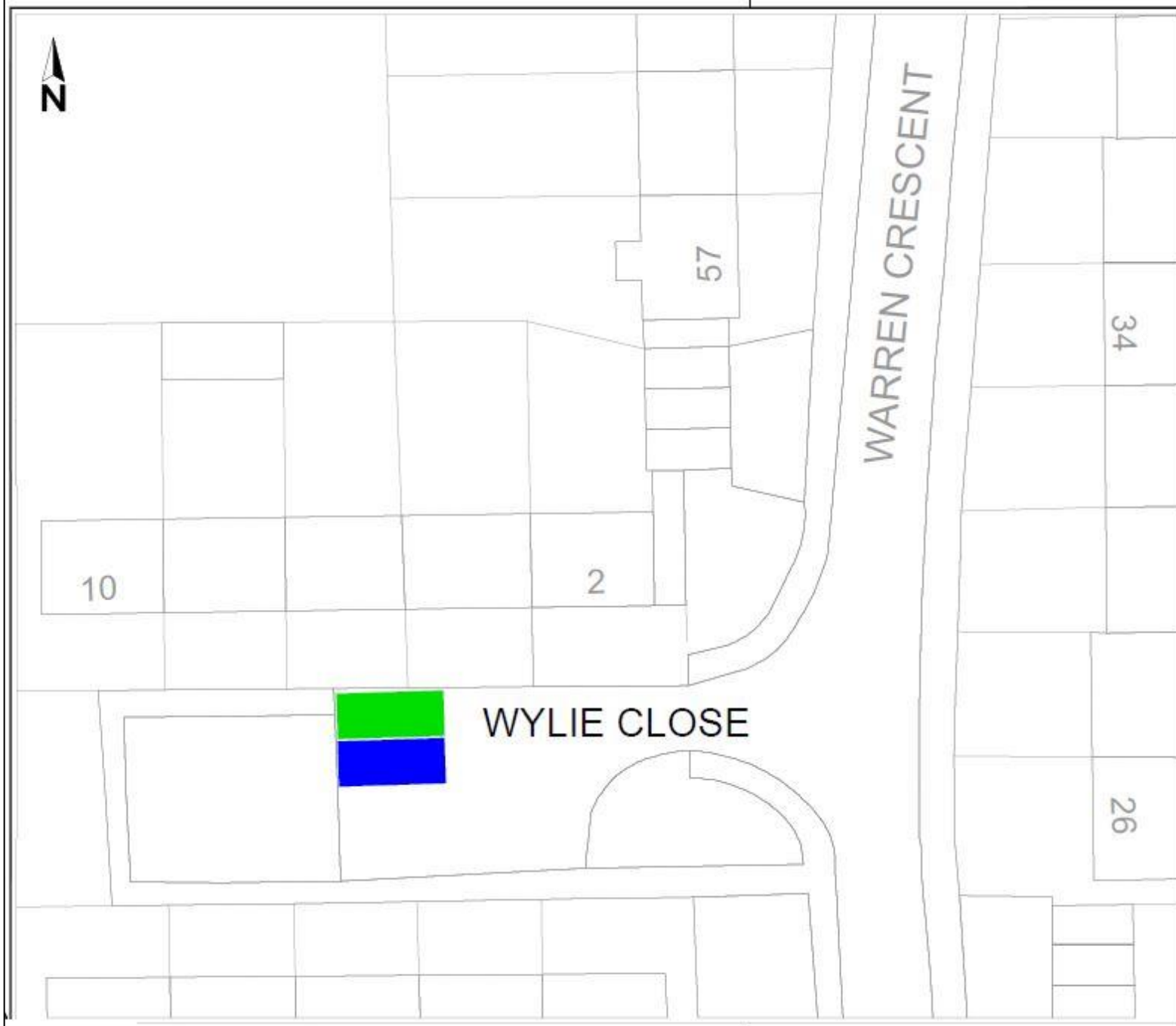

| RESPONDENT | SUMMARISED COMMENTS |
|---|--|
| (1) Traffic Management Officer, (Thames Valley Police) | No objection |
| <i>Corunna Crescent (Oxford) - Proposed removal of DPPP</i> | |
| (1) Local Resident, (Oxford) | <p>Concerns (Corunna Crescent - removal) – We have no objections to the disabled space remaining . While it is not in use by the current occupier, who is elderly, there are two residents who are very close who are disabled, and it could be used for them if it were needed.</p> <p>Our side of the Crescent have dropped our kerbs and park off road, this makes traffic flow around the Crescent easier . We don't want to encourage more parking from non-residents .</p> <p>If this was to become a normal space then we would again have difficulty in reversing off our drive, as people would just park and not consider that.</p> |
| (2) Local Resident, (Oxford) | <p>Concerns (Corunna Crescent - removal) - I had a really nasty accident which has left me with a disability that has made it very difficult to walk and have actually been issued with a blue badge. Can I please ask for the time being this remains in place please.</p> |
| (3) Local Resident, (Oxford) | <p>Objection (Corunna Crescent – removal) - My Mum is registered disabled and a Blue Badge holder and regularly uses this space. We would strongly like to object to this proposal as the parking place has been a lifeline to her. She is unable to walk very far and relies on friends and family collecting her and dropping her off in this space.</p> <p>If it is possible to keep the Disabled Person Parking Place, we would be very grateful.</p> |

| | |
|--|--|
| <i>Gentian Road (Oxford) – Proposed new DPPP</i> | |
| (4) Local Resident, (Oxford) | Support (Gentian Road) – I have read the proposed parking letter in Gentian Road, that's the best place for the parking and I would be happy if it got the go ahead |
| <i>Norreys Avenue (Oxford) - Proposed new DPPP</i> | |
| (5) Local Resident, (Oxford) | <p>Support (Norreys Avenue) - As I am a potential beneficiary of the space, I declare myself whole-heartedly in support. Currently I have to vie for the existing space with my neighbour but one who is also a Blue Badge holder.</p> <p>Additionally, the existing space in Norreys Avenue is quite often occupied by non-Blue Badge holders. I believe that this is in no small part down to the almost invisible paintwork on the existing space. While aware of the cost implications, I hope that the site paintwork may be reworked before long (possibly when the work is undertaken on the new apace).</p> |
| (6) Local Resident, (Oxford) | Support (Norreys Avenue) - Just to say I endorse the applicant's declaration of support for a second disabled persons parking space in Norreys Avenue. It is badly needed. |
| <i>Park Town (Oxford) - Proposed new DPPP</i> | |
| (7) Local Resident, (Oxford) | Support (Park Town) - I support the creation of a new disabled space for my neighbour. |

Stile Road (Oxford) - Proposed new DPPP

(8) Local Resident,
(Oxford)

Object (Stile Road) - As residents in Stile Road, we object to the turning of a current parking bay into a disabled parking bay. There is limited parking as it is in Stile Road, and this will remove one of the spaces for other resident use.

We already fight for parking space with local traders. Instead, I suggest you use the bay at the end of the street by the Coop which is, I believe, not currently used for permit parking.

I also recommend sending traffic wardens back to Stile Road, there are huge numbers of cars parked illegally at the entrance to Stile Road at all times day and night, they could make a killing.

I appreciate you logging this objection

(9) Local Resident,
(Oxford)

Support (Stile Road) - This is excellent for our neighbour. However, might I propose that you put it outside our house as this will allow her to drive in and not to have to reverse in and navigate other cars parking either side of the proposed space, this would be much better for her and her arthritis.

Sunningwell Road (Oxford) - Proposed new DPPP

(10) Local Resident,
(Oxford)

Object (Sunningwell Road) - This is a mild objection to the proposal for the positioning of a disabled parking bay on Sunningwell Road. Currently it is on the north side of the road outside house numbers 4 & 6.

Might I offer a more suitable position to be on the south side of the road outside number 2, directly after the end of the double yellow lines at the edge of the west side of the pub car park? This would give the user space to remove a ramp from their car, should they need it, without worrying about a car parked directly behind them as there would only be the double yellows.

This seems a more reasonable position to me as the current proposed position would cause problems as the cars that end tend to be very tightly parked together, especially when there are events going on at the pub.

| | |
|----------------------------------|--|
| | |
| (11) Local Resident, (Oxford) | <p>Object (Sunningwell Road) - Unnecessary. If Disabled persons, in this immediate vicinity, are to be accommodated, say for visiting the Duke of Monmouth, Podiatry Clinic or possibly the Chiropractic Clinic; then the obvious location would be on the South side of Sunningwell Road, outside the Duke of Monmouth where few residents park their vehicles.</p> <p>There are several houses at the proposed location, all with young children, that need their vehicles parked near their homes. The proposed location severely impacts on immediate neighbours in an area of premium parking spaces.</p> |
| (12) Local Resident, (Oxford) | <p>Object (Sunningwell Road) - Sunningwell road is a very pressured road in terms of its parking. It's already has to host the daily overflow from the duke of Monmouth pub carpark but it is also used as the local parking for the houses along the Abingdon road (256- 244) which are mostly multi occupancy and have 8 cars daily that I know of that park dotted around the proposed site for the disabled bay as well as the residents of the street that mostly pay for residents parking permits.</p> <p>The road is also a very narrow road in which all cars have to mount the pavement and park bumper to bumper on the side of the proposed bay in order to leave enough space for delivery vans and the emergency services etc, In doing so the possibilities of vehicles doors being able to achieve a fully open position are reduced significantly and especially around the area of the entrance to the pub carpark which twice weekly has 18tonne lorries making turns in and out of it as well as the daily patrons work vans and cars.</p> <p>A disabled bay isn't the problem for the street in theory but in practically the proposed location is all wrong, if a disabled bay was to be placed on the street the best place for it would be on the opposite side of the road by the duke of Monmouth's disabled ramp where the pavement is twice as wide providing patrons to the pub easy accessibility and anyone else using the street easy access to the crossings and the only lowered curbs for wheel chair access/walking frames or assisted walking for the entire length of the street.</p> <p>If the councils aim is to benefit disabled persons as a whole the proposed site is not advantageous.</p> |

| | |
|--|--|
| <p>(13) Local Resident, (Oxford)</p> | <p>Object (Sunningwell Road) - I am a resident of Sunningwell Road and am objecting for the following reasons. (1) The available resident parking on street near to the Duke of Monmouth is very limited due to patrons of the pub using on street parking spaces as overflow to the pub. (2) Sunningwell Road is narrow and consequently the residents need to park partially on pavements, often restricting free movement of pedestrians along the pavement. Clearly the same difficulties would apply for somebody with disabilities, so I would have concerns about safety. (3) The Duke of Monmouth has regular delivery and pick-ups of beer barrels. Usually these come in a lorry which requires sufficient turning space in and out of the car park to the back of the pub. In addition, any person parking here would need to deal with all the coming and going traffic of the pub. Again, my concern would be on grounds of safety due to the limited turning space and traffic coming into and out of the pub car park.</p> |
| <p>(14) Local Resident, (Oxford)</p> | <p>Concerns (Sunningwell Road) - There is disabled access to the pub, Duke of Monmouth is on the left at the top of the road. Generally, there are few vehicles on the left, directly outside the pub since residents' park outside their houses. A disabled place in this location could be utilised readily for patrons of the pub & not impact the residents.</p> <p>There are no disabled persons in the intended location, in fact the proposed site is moving the space away from where it would be utilised most & well positioned for the Chiropody clinic just around the corner.</p> |
| <p>(15) Local Resident, (Oxford)</p> | <p>Concerns (Sunningwell Road) - I wish to raise concerns over the above.</p> <ol style="list-style-type: none"> 1. If the Councils directive is to provide a facility in every residential street: Then this proposed site is not practical. The disabled ramp for entry into the Duke of Monmouth pub is on the South side of the road. The pavement is wider, in fact, 3 times the width outside the pub. The Podiatry Clinic is also south, on the corner of Lincoln Road. 2. Residential parking at the top of S'well Rd/Abingdon Rd is premium: it is pressured by vehicles from residents on Abingdon Road (at least 8 cars) Plus, overflow from the pub carpark. It is not an assumption that anyone would be able to park in front of their residence, all the time. A designated space on the north side <i>severely reduces parking for 7 homes with small children.</i> <p>If this particular Disabled Space, in this proposed position, were implemented, it automatically creates (as intended)</p> |

| | |
|---|---|
| | <p>a) Reserved & free parking for 1 household. b) Daily use by extended family for commuting to town. c) it would never benefit <i>a genuinely disabled person</i> since it would be blocked by 1 household only. <i>Therefore, useless.</i></p> <p>3. All households are required to pay £65 per year, per vehicle. Not all residents agree that this is acceptable. Possession of a Blue Badge only indicates that the owner has successfully acquired it. Nothing more.</p> |
| <p><i>Waynflete Road (Oxford) - Proposed new DPPP</i></p> | |
| <p>(16) Local Resident, (Oxford)</p> | <p>Support (Waynflete Road) - We support the introduction of disabled parking spaces especially if a real mobility issue exists. Note however that in this area every house has a drive, and so we invite you to check if a disabled parking spot on public land is really needed or if it represents an unnecessary expenditure of public money for private gain. Our understanding is that a disabled parking space can be reserved only where a private drive is not available. Further, the blue parking rectangle in the drawing you supplied (which is missing the scale) looks big enough for a bus. This almost certainly blocks part of the drive to No.42 (which is not represented in your drawing) which would make it difficult if at all possible to manoeuvre in and out of it. Is the parking bay needed for wheelchair access through the back of the car or is it just a reserved parking bay? So, if a disabled bay has to be created, we kindly ask you to ensure that it is commensurate with the size needed. Surely whatever the motive, it should be respectful of the access to the nearby property.</p> |
| <p><i>Wharton Road (Oxford) - Proposed new DPPP</i></p> | |
| <p>(17) Local Resident, (Oxford)</p> | <p>Object (Wharton Road) - I would like it to be recorded that I strongly object to the disabled space at the proposed location.</p> <p>Reasons for objection.</p> |

| | |
|---|---|
| | <ol style="list-style-type: none"> 1. The applicant who is applying for the disabled space has three cars at the household. One of the cars is parked constantly at the proposed location. This means I have to look for alternative parking. 2. Their other car is parked outside the front of their house and never moves. It would appear that this car is used for storage of boxes etc. 3. The applicant also has another car that is parked in a parking space inside the boundary of their property. 4. There are plenty of parking spaces directly opposite their house that could be converted into a disabled parking space. <p>I question why they are applying for the disabled space. Why can't the Tesla car that is parked inside the property be moved onto the public street and the mini which has the disabled badge be parked in the space within their property. The car would then be closer to the front of their house and there would be no need for the disabled parking space.</p> <p>Currently there are two parking spaces. According to the drawing sent through with the letter this will be cut down to one disabled space outside the front of both houses. This will mean we will always have to find alternative parking.</p> <p>It is my opinion that the disabled space should be situated directly opposite the applicant's house where there are plenty of parking spaces.</p> |
| <p><i>Wylie Close (Oxford) - Proposed formalisation of DPPP</i></p> | |
| <p>(18) Local Resident, (Oxford)</p> | <p>Support (Wylie Close) - I would be great full if this was turned into a formal bay. This has helped myself and my son's anxiety, knowing that our vehicle is in sight of our property it has allowed myself to support his needs through the day and night.</p> |
| <p>(19) Local Resident, (Oxford)</p> | <p>Concerns (Wylie Close) - I'm not sure if you are aware that the original, existing disabled parking space in the Close was installed for residents who used to live at number 4, who actually moved away from the Close about a year ago. The new occupants do not appear to own a blue badge and always park in the driveway of their house.</p> <p>The second, informal disabled space to which this consultation refers appears to have been installed for the residents of number 6 who have recently acquired a blue badge, and because it is the bay closest to their house, it allows them access to their own driveway, which they converted during the lockdown because they own two large vehicles. Whilst they use this new, informal disabled space for one of their vehicles, they do not use the original, existing disabled space, as they have their own driveway for their second vehicle.</p> |

It should be noted that since the second disabled space was added, the original, existing disabled space has not once been used by a blue badge holder, as the residents for whom it was originally installed no longer live here, so there is no need for more than one disabled space in the Close. If the Council wishes to verify this, they could undertake a survey to ascertain how many residents living in Wylie Close have a blue badge and need a designated disabled space (and don't already have their own driveway they could be parking in).

As parking is extremely limited in the Close and 6 out of the 10 houses are unable to have their own driveways because of how the Close is configured, I would therefore like to request that this original, existing disabled space now revert back to being a normal parking space, to enable those of us not able to install our own driveways more opportunity to park inside the Close.

Having unsuccessfully tried to sell my property over the past two years, the single most frequently cited reason prospective buyers gave for why they were put off purchasing the house was the lack of parking, so this situation (which is beyond my control) has adversely affected the saleability of my house. Although I love the green space in front of my house and would not want it removed to make more parking, I do wish that the remaining parking spaces in the Close were designated for those houses whose occupants own a car but cannot have their own driveways. I would also appreciate it if more could be done to prevent residents from parking illegally in the Close and blocking people in.